

whiteley helyar



525 ft²



bedroom



bathroom



*residents
parking
permit*

Guide Price

£245,000

Flat 5, 44 Bathwick Street, Bath, BA2 6PA

Flat 5, 44 Bathwick Street, Bath, BA2 6PA

DESCRIPTION

A period conversion top floor apartment, situated between Henrietta Park and Sydney Gardens, allowing fantastic access into the city centre. With lovely urban views to both sides, this nicely proportioned flat has good sized principle rooms with lots of natural light.

ACCOMMODATION

sitting/dining room
kitchen
double bedroom with built-in storage
bathroom

LOCATION

The flat occupies a very popular and convenient location, being close to the refurbished Sydney Gardens, Henrietta Park and the Kennett and Avon Canal. The city centre (with its wide range of shops, restaurants, Bath Spa Railway Station, Bath Recreation Rugby Ground and other amenities) are all within easy walking distance, whilst the M4 can be accessed without having to cross the city.





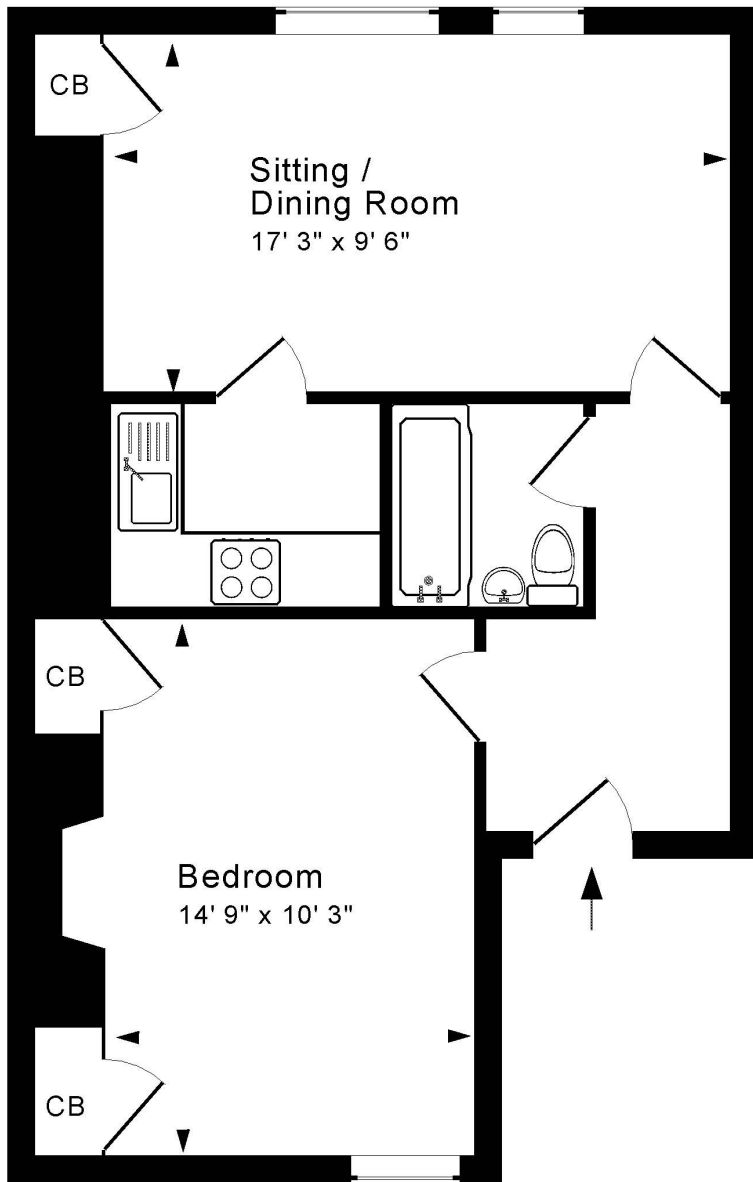

Approx. Gross Internal Floor Area 525 Sq. Ft. / 49 Sq. M
 Includes Conservatories. Excludes Garages, Porches etc. unless stated
 For identification purposes only. Not to scale. Copyright Jemesis Ltd 2024
 Drawing Number: 172-0747
 Flat 5, 44 Bathwick Street, Bath, BA2 6PA.

Tenure: Leasehold
Service charge: £176.23 per month
Council tax band: 'B' = £1,638.83 pa

